

# PROFESSIONAL ROW II COMMERCIAL OFFICE BUILDINGS FOR SALE

MAUI • LANI

## VILLAGE CENTER

The Dynamic Center of Maui's Premier Master - Planned Community



*Fee Simple professional commercial office buildings to be built on Lots 54 through 57 with ground floor areas of approximately 2,112 square feet and 747 square feet on the second floor. Beautiful landscaping with parking that meets code requirements to accommodate medical and professional office use.*

Lot #	Land Sq.Ft.	Ground Floor Sq.Ft.	Second Floor Sq.Ft.	Price
54	10,549	2,112	747	\$1,075,000
55	9,533	<b>P E N D I N G</b>	<b>P E N D I N G</b>	\$999,000
56	9,267	2,112	747	\$999,000
57	9,512	2,112	747	\$999,000

Exclusively Offered by:



COMMERCIAL PROPERTIES  
OF MAUI

FOR MORE INFORMATION, CONTACT:

**Grant Howe, CCIM (PB)**

**Ben Walin, CCIM R (B)**

ghowe@mauibiz.com

bwalin@ccim.net

**808.244.2200**

2145 Wells Street • Suite 105 • Wailuku, HI 96793-2225 • mauibiz.com

### HIGHLIGHTS

- Zoned - VMX - Village Mixed Use, which allows for commercial & residential use
- Architecturally-designed individual buildings with landscaping and parking that meets code requirements for medical and professional office use.
- Buildings delivered in shell condition.
- Customized interior build outs with initial space planning services available.
- Commercial financing available for owner/users with 10% down subject to SBA 504 loan qualification.
- Take advantage of tax benefits derived from ownership.
- To be built late 2014.

*Commission to cooperating brokers is 2.5% of sales price.*

# PROFESSIONAL ROW II COMMERCIAL OFFICE BUILDINGS FOR SALE

MAUI LANI

## VILLAGE CENTER

The Dynamic Center of Maui's Premier Master - Planned Community

### LOT 54

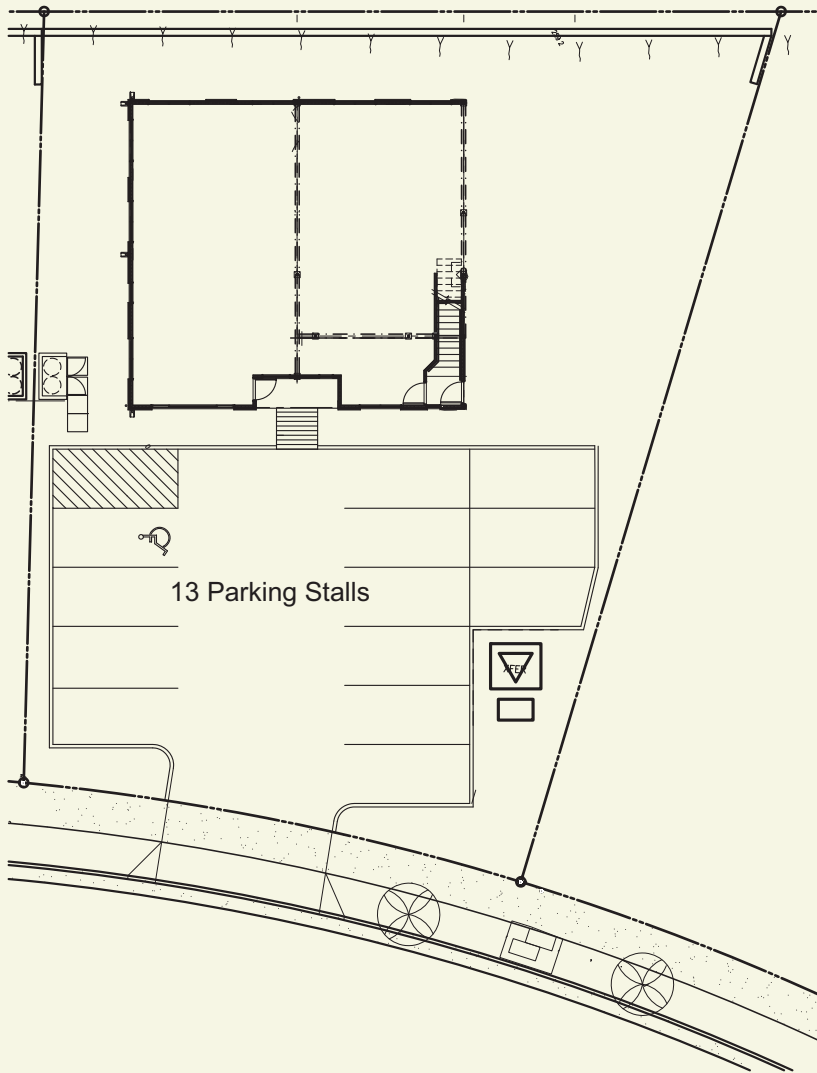

### Join Our Professional Office Owners

Retina Institute of Hawaii ♦ Wailuku Federal Credit Union  
Rainbow Tax & Financial Services ♦ Maui Lani Physicians  
& Surgeons ♦ Maui Primary Care Physicians ♦ Dean S.  
Arashiro, DDS ♦ Wei Wei Holdings LLC

### LOT 55, 56 & 57

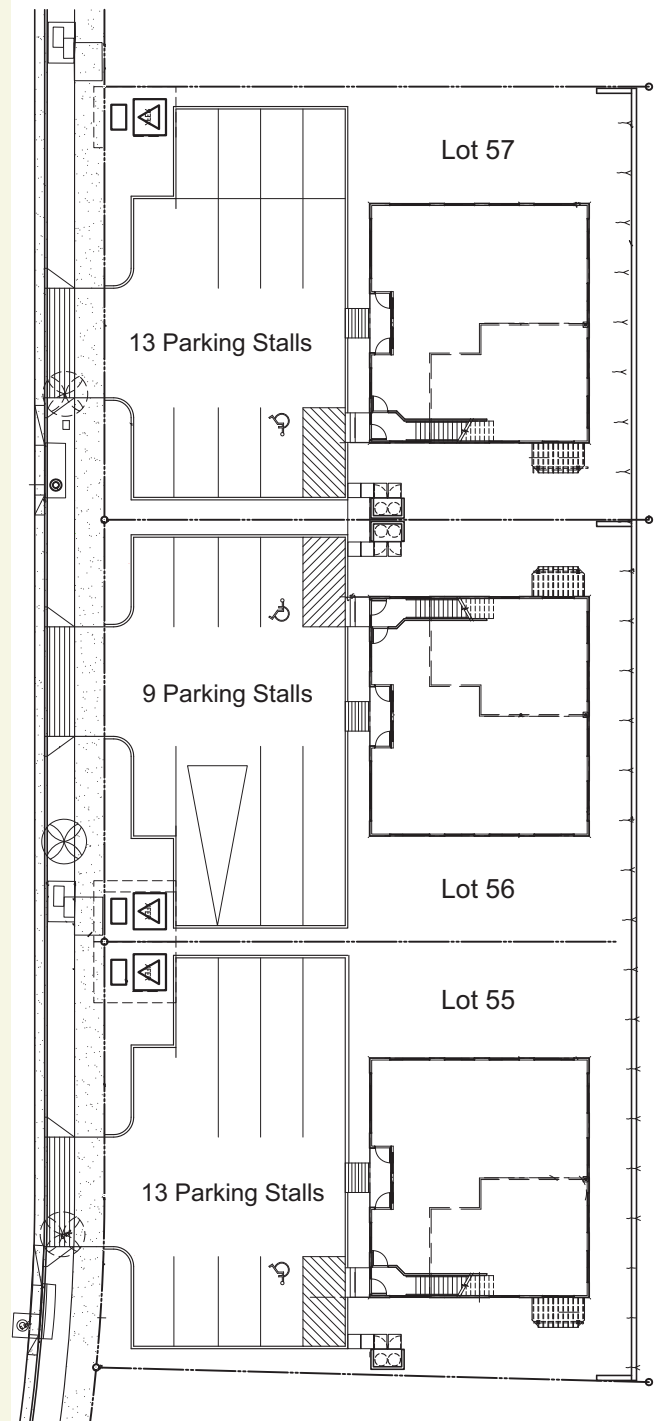

COMMERCIAL PROPERTIES  
OF MAUI

Grant Howe, CCIM (PB) | [ghowe@mauibiz.com](mailto:ghowe@mauibiz.com)

Ben Walin, CCIM R(B) | [bwalin@ccim.net](mailto:bwalin@ccim.net)

**808.244.2200**

2145 Wells Street • Suite 105 • Wailuku, HI 96793-2225 • [mauibiz.com](http://mauibiz.com)