



COMMERCIAL PROPERTIES OF MAUI LLC

SUITE 400, 1955 MAIN STREET, WAILUKU, HAWAII 96793

PHONE (808) 244-2200 FAX (808) 243-8614

WWW.MAUIBIZ.COM

Office Space FOR LEASE

**33 Lono Avenue, Suite 140
Kahului, Maui TMK (2)3-7-7-10**



1 st Floor Office:	Unit 140	926 sq.ft.
Base Rent:	\$2.28 s.f.	
CAM:	\$1.42 s.f.	
Available:	NOW	
Term:	3-5 years	
Comments:	Sublease Ground Floor office. Great Location CAM includes central a/c and utilities. Ample parking	

LEASING AGENT:

Commercial Properties of Maui LLC
Grant Howe, CCIM ghowe@mauibiz.com
Scott Kenar, RS skenar@mauibiz.com
(808) 244-2200

The information contained herein comes from sources deemed reliable, but no warranties or guarantees as to the accuracy of the information should be construed.



**Individual
Member**

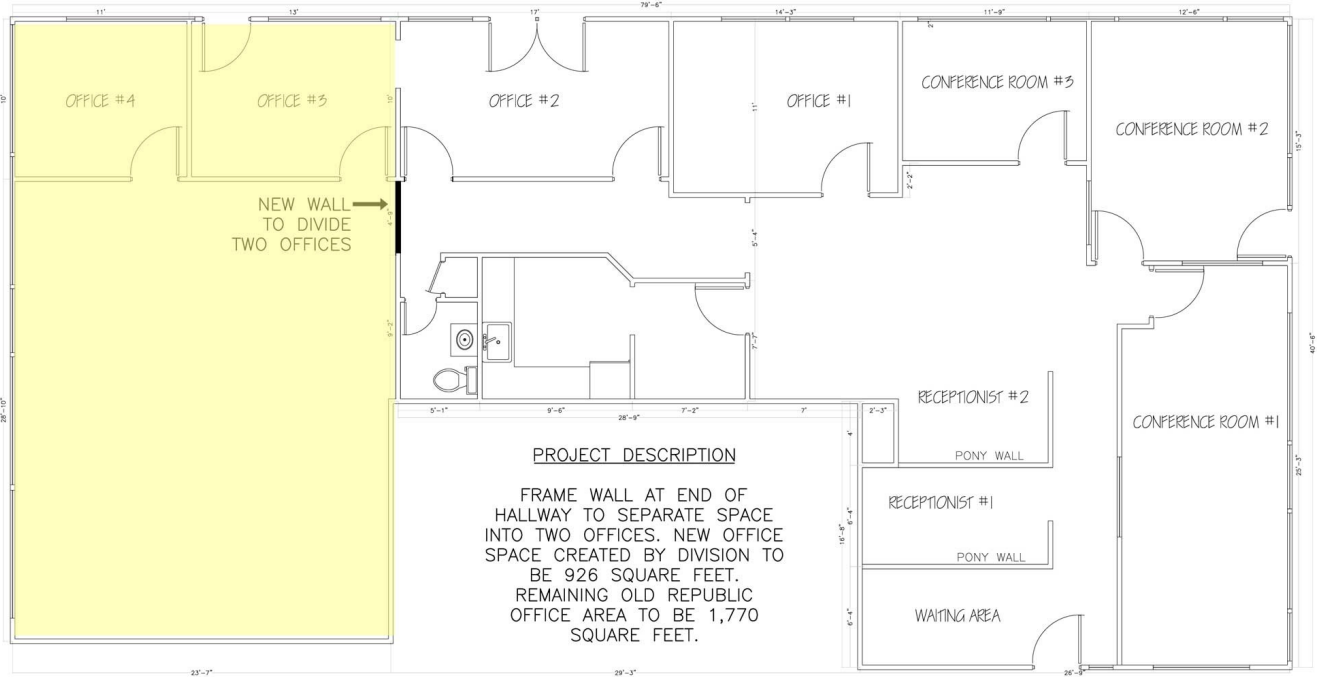

PROJECT DESCRIPTION

FRAME WALL AT END OF HALLWAY TO SEPARATE SPACE INTO TWO OFFICES. NEW OFFICE SPACE CREATED BY DIVISION TO BE 926 SQUARE FEET. REMAINING OLD REPUBLIC OFFICE AREA TO BE 1,770 SQUARE FEET.

FLOOR PLAN
SCALE: 3/16" = 1'

mm
marian macy zajac
422 kaupakoula rd.
hale, hawaii 96706
phone/fax 973-9229
drafting and design services

OLD REPUBLIC
TITLE & ESCROW OF HAWAII
33 LONO AVE., SUITE 140
KAHULUI, MAUI, HAWAII

PAGE
ONE
OF ONE
FLOOR PLAN

FLOOR PLAN

The information contained herein comes from sources deemed reliable, but no warranties or guarantees as to the accuracy of the information should be construed.

